



ESBE AB  
Bruksgatan 22  
SE-333 75 Reftele  
www.esbe.eu



Mtrl.nr: 98141052 • Ritn.nr: 7783 • vers. C • 2023-10-25



ESBE System Units  
DOUBLE CIRCULATION UNIT  
**SERIES DxA100**



Series DDA111

Series DAA111

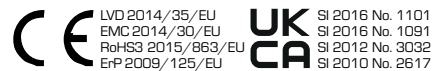

PED 2014/68/EU, article 4.3  
EnEV 2014

SI 2016 No. 1105

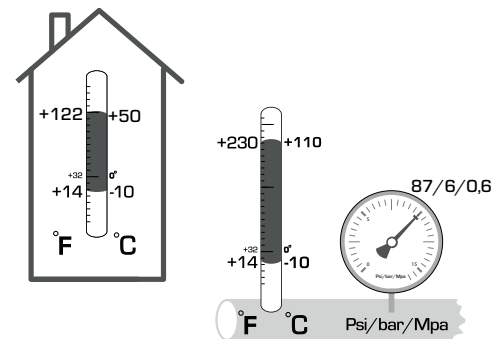

**SERIES**      **FUNCTION**

DAA111

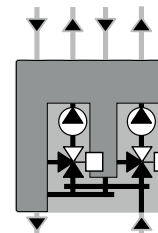

DDA111

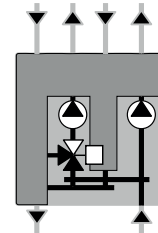

**Dimensions**

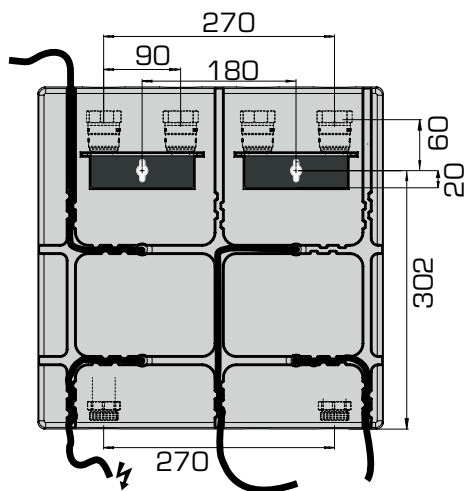

4



**Mounting position**

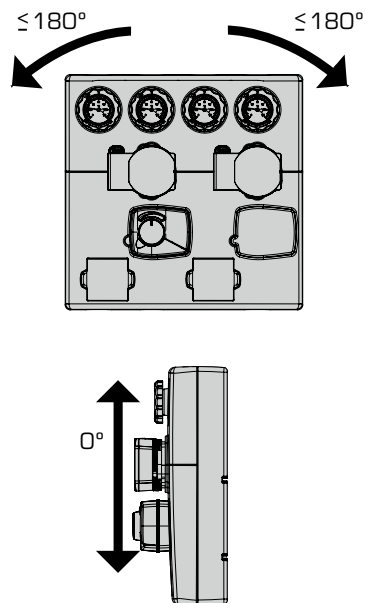

**Remove actuator**

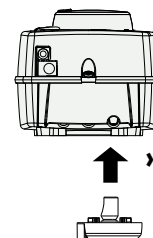
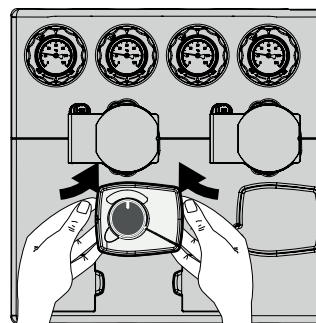

**Remove insulation**

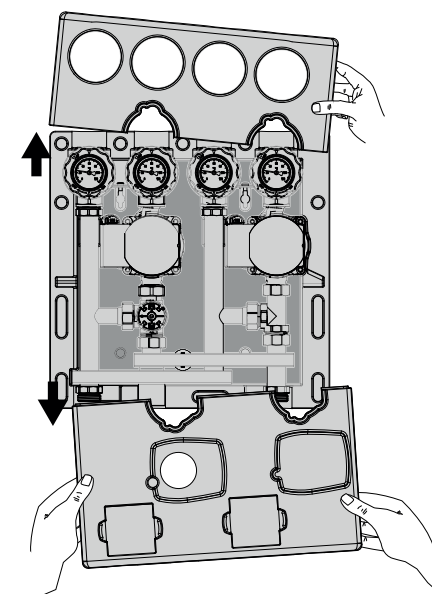

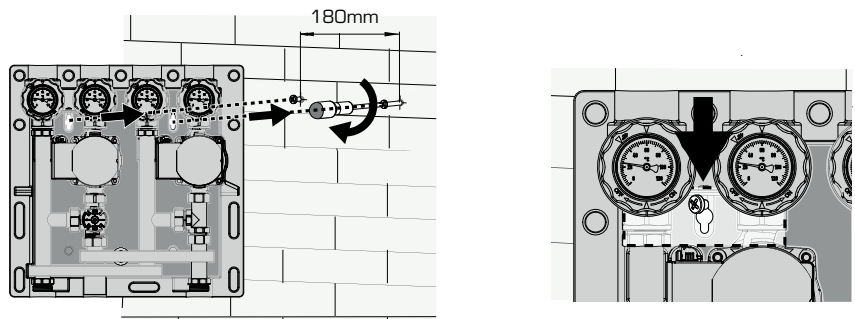
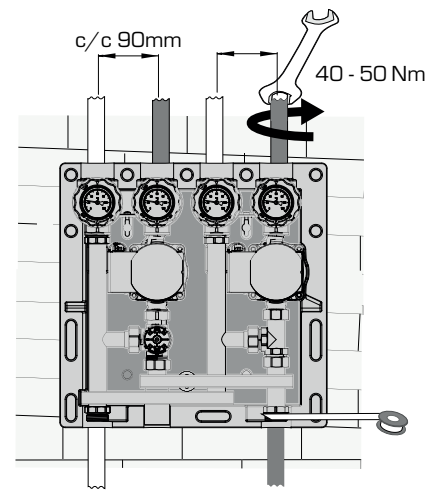
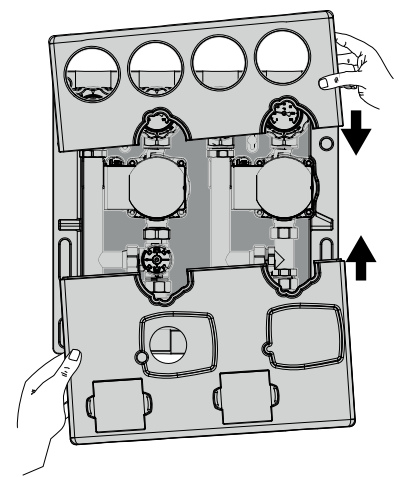
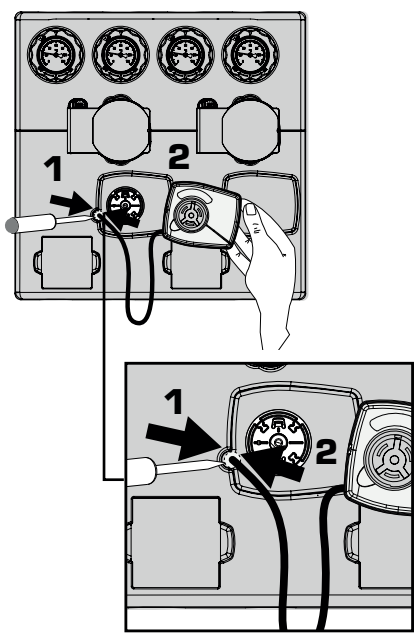
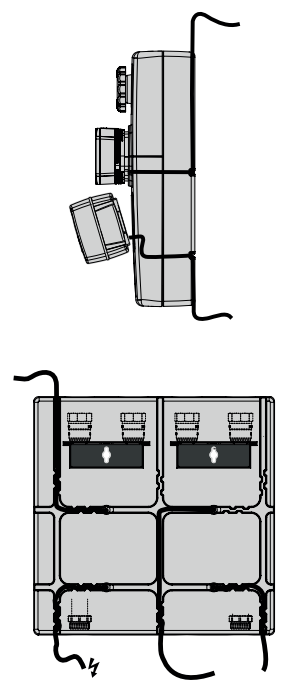
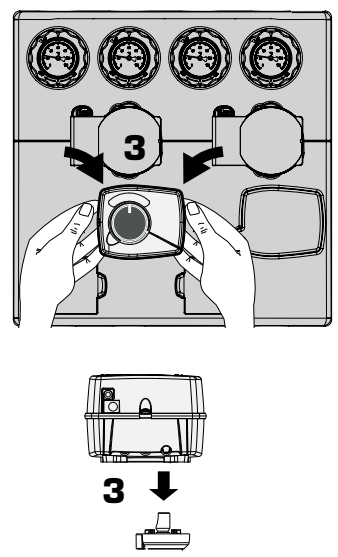
**3****Assembling on wall****4****Fit supply pipes****5****Mount the insulation****6****Mount the cables****7****Cabling****8****Assemble actuator**



### Electric installation

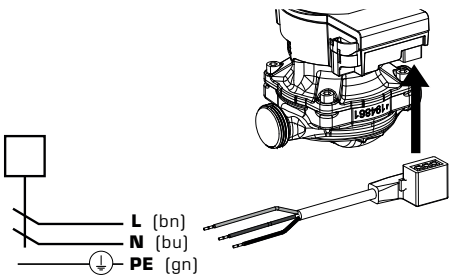
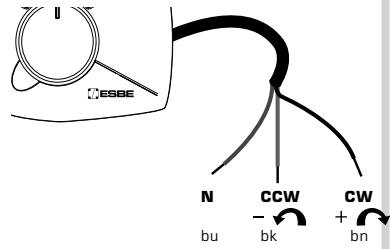

### Commissioning actuator

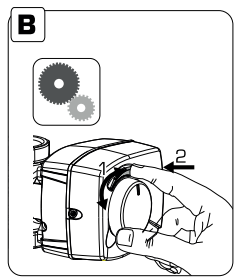
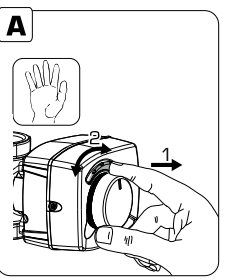

<https://esbe.eu/group/products/rotary-actuators>

# 9



### By-pass ON/OFF

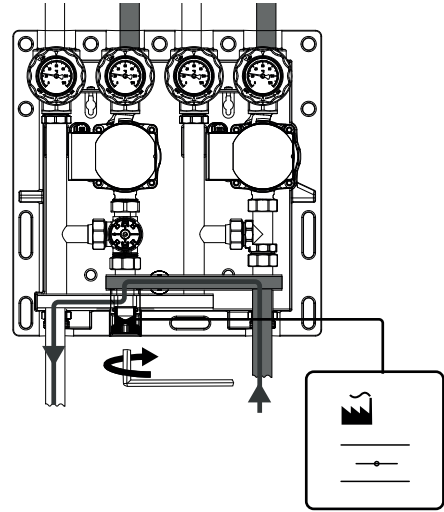

6 ↶ = By-pass closed  
6 ↷ = By-pass open

∅10 mm

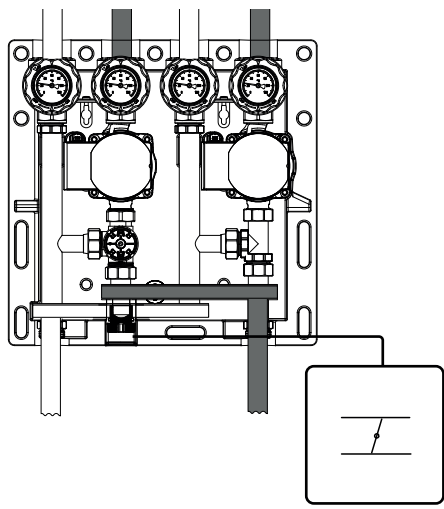

### Commissioning

#### Preparation

- 1
- 2 20 MINUTES

#### Filling and venting

- 1 Open
  - 2 Filling and venting
-

### Wilco Display

**NORMAL OPERATION** **FAULT**

**CONTROL MODE**  
 Variable differential pressure -  $\Delta p-v$   
 Constant differential pressure -  $\Delta p-c$   
 Constant speed

**PUMP CURVE**  
 I, II, III

### Pump Settings

**LED display**

**Status**

- Locked
- Unlocked
- Venting
- Manual restart
- Factory setting

### Settings navigations

**LED display** **Control mode** **Pump setting**

**Recommended** **Alternative**

- 1 Constant speed
- 2 Constant speed
- 3 Variable differential pressure
- 4 Variable differential pressure
- 5 Variable differential pressure
- 6 Constant differential pressure
- 7 Constant differential pressure
- 8 Constant differential pressure
- 9 Constant speed

### WILO - Faults, Causes and Remedies

LED	Faults	Cause	Remedy
Lights up red	Blocking	Rotor blocked	Activate manual restart or contact customer service
	Contacting/ winding	Winding defective	
Flashes red	Under/overvoltage	Power supply too low/high on mains side	Check mains voltage and operating conditions, and request customer service
	Excessive module temperature	Module interior too warm	
	Short-circuit	Motor current too high	
Flashes red/green	Generator operation	Water is flowing through the pump hydraulics, but there is no mains voltage at the pump	Check the mains voltage, water quantity/pressure and the ambient conditions
	Dry run	Air in the pump	
	Overload	Sluggish motor; pump is operated outside of its specifications (e.g. high module temperature). The speed is lower than during normal operation	

<http://www.esbe.eu/global/en/products/circulation units>

### Factory setting

= Factory settings

### Nameplate

### Expose application info using leaflet