

CONNECTION KIT SERIES KTB100



KTB100
Internal thread

ESBE connection kits for valves with external thread.
One package / port.

SUITABLE VALVES

The connection kit series KTB100 may most easily be fitted with ESBE control valve:

- Series VLE122
- Series VLE132

TECHNICAL DATA

Max. working pressure: _____ PN 16
 Max. temperature of medium: _____ +150°C
 Min. temperature of medium: _____ -20°C
 Connection: _____ Internal thread, EN 10226-1
 _____ External thread, ISO 228/1

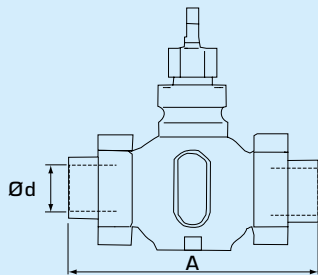

INTERNAL THREAD CONNECTION, SERIES KTB112

Material _____
 Union nut: _____ Malleable iron casting, galv.
 Union end: _____ Malleable iron casting, galv.
 Standard gasket: _____ Klingersil C4400

ERC

SERIES KTB112, FITTINGS INTERNAL THREAD (1 PACKAGE/PORT)

Art. No.	DN	Valve thread	Connection Ød	A (VLE100/VLE200)	Weight [kg]	Note
26100700	15	G 1"	Rp 1/2"	146	0,12	
26100800	20	G 1 1/4"	Rp 3/4"	146	0,20	
26100900	25	G 1 1/2"	Rp 1"	159	0,23	
26101000	32	G 2"	Rp 1 1/4"	169	0,41	
26101100	40	G 2 1/4"	Rp 1 1/2"	197	0,45	
26101200	50	G 2 3/4"	Rp 2"	222	0,64	