

# CONNECTION KIT

## SERIES KTB112, KSB114 AND KWB118

ESBE connection kits for valves with external thread.  
One package / port.



KTB100  
Internal thread



KSB100  
Soldering type



KWB100  
Welded type

### SUITABLE VALVES

The connection kit series KTB112, KSB114 and KWB118 may most easily be fitted with ESBE control valve:

- Series VLE122, 222
- Series VLE132

#### TECHNICAL DATA

Max. working pressure: \_\_\_\_\_ PN 16  
 Max. temperature of medium: \_\_\_\_\_ +150°C  
 Min. temperature of medium: \_\_\_\_\_ -20°C  
 Connection: \_\_\_\_\_ Internal thread, EN 10226-1  
 \_\_\_\_\_ External thread, ISO 228/1

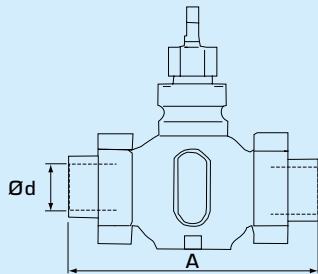

#### INTERNAL THREAD CONNECTION, SERIES KTB112

Material  
 Union nut: \_\_\_\_\_ Malleable iron casting, galv.  
 Union end: \_\_\_\_\_ Malleable iron casting, galv.  
 Standard gasket: \_\_\_\_\_ Klingsil C4400

#### SOLDERING TYPE CONNECTION, SERIES KSB114

Material  
 Union nut: \_\_\_\_\_ Brass, CW614N  
 Union end: \_\_\_\_\_ Bronze, SS5204  
 Standard gasket: \_\_\_\_\_ Klingsil C4400

#### WELDED TYPE CONNECTION, SERIES KWB118

Material  
 Union nut: \_\_\_\_\_ Malleable iron casting, galv.  
 Union end: \_\_\_\_\_ Steel SS1312  
 Standard gasket: \_\_\_\_\_ Novatec eco

### SERIES KTB112, FITTINGS INTERNAL THREAD (1 PACKAGE/PORT)

Art. No.	DN	Valves thread	Connection Ød	A (VLE100/VLE200)	Weight [kg]
26100700	15	G 1"	Rp 1/2"	146	0.12
26100800	20	G 1 1/4"	Rp 3/4"	146	0.20
26100900	25	G 1 1/2"	Rp 1"	159	0.23
26101000	32	G 2"	Rp 1 1/4"	169	0.41
26101100	40	G 2 1/4"	Rp 1 1/2"	197	0.45
26101200	50	G 2 3/4"	Rp 2"	222	0.64

### SERIES KSB114, FITTINGS SOLDERING TYPE (1 PACKAGE/PORT)

Art. No.	DN	Valves thread	Connection Ød	A (VLE100/VLE200)	Weight [kg]
26101300	15	G 1"	15 mm	136	0.13
26101400	20	G 1 1/4"	22 mm	146	0.19
26101500	25	G 1 1/2"	28 mm	155	0.23
26101600	32	G 2"	35 mm	163	0.45
26101700	40	G 2 1/4"	42 mm	200	0.48
26101800	50	G 2 3/4"	54 mm	232	0.77

### SERIES KWB118, FITTINGS WELDED TYPE (1 PACKAGE/PORT)

Art. No.	DN	Valves thread	Connection Ød	A (VLE100/VLE200)	Weight [kg]
26100100	15	G 1"	21.3 mm	182	0.12
26100200	20	G 1 1/4"	26.9 mm	182	0.19
26100300	25	G 1 1/2"	33.7 mm	187	0.25
26100400	32	G 2"	42.4 mm	197	0.44
26100500	40	G 2 1/4"	48.3 mm	232	0.46
26100600	50	G 2 3/4"	60.3 mm	262	0.66